

4 3 2 1

| UNIT SPECIFICATIONS | | | | | | | |
|---------------------|-----|------|----------|----------|---------|----|-------|
| Part Number | kW | KVAR | Max Amps | HARMONIC | VOLT | Hz | PHASE |
| 108643-02 | 355 | 139 | 640 | 5TH | 380-415 | 50 | 3 |

SCHEMATIC : 31582

- Notes:
1. Customer is responsible for installation to meet all national and local electrical codes.
 2. Use only hubs or fittings that comply with UL514B for type 3R enclosures.
 3. cULus Listed UL 508A File E140832
 4. Enclosure Color: RAL 7006 Beige Grey
 5. Approx. WT LBS : 1200

GROUND LUG:
WIRE RANGE - TWO 600MCM-2
TIGHTENING TORQUE 500 LB-IN.

| | | | | | |
|----|----|----|----|----|----|
| L1 | L2 | L3 | T1 | T2 | T3 |
|----|----|----|----|----|----|

CUSTOMER CONNECTIONS:
WIRE RANGE - TWO 600MCM-2
TIGHTENING TORQUE 500 LB-IN.

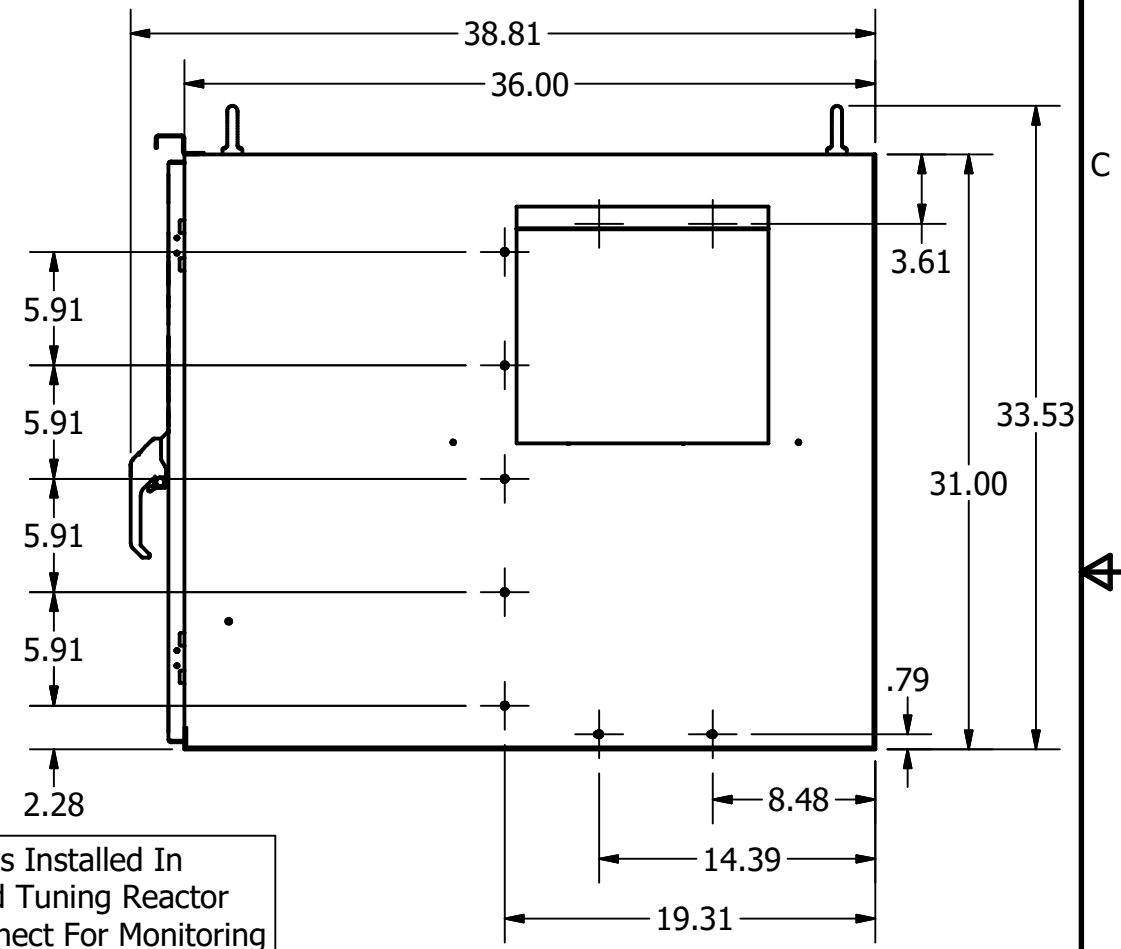
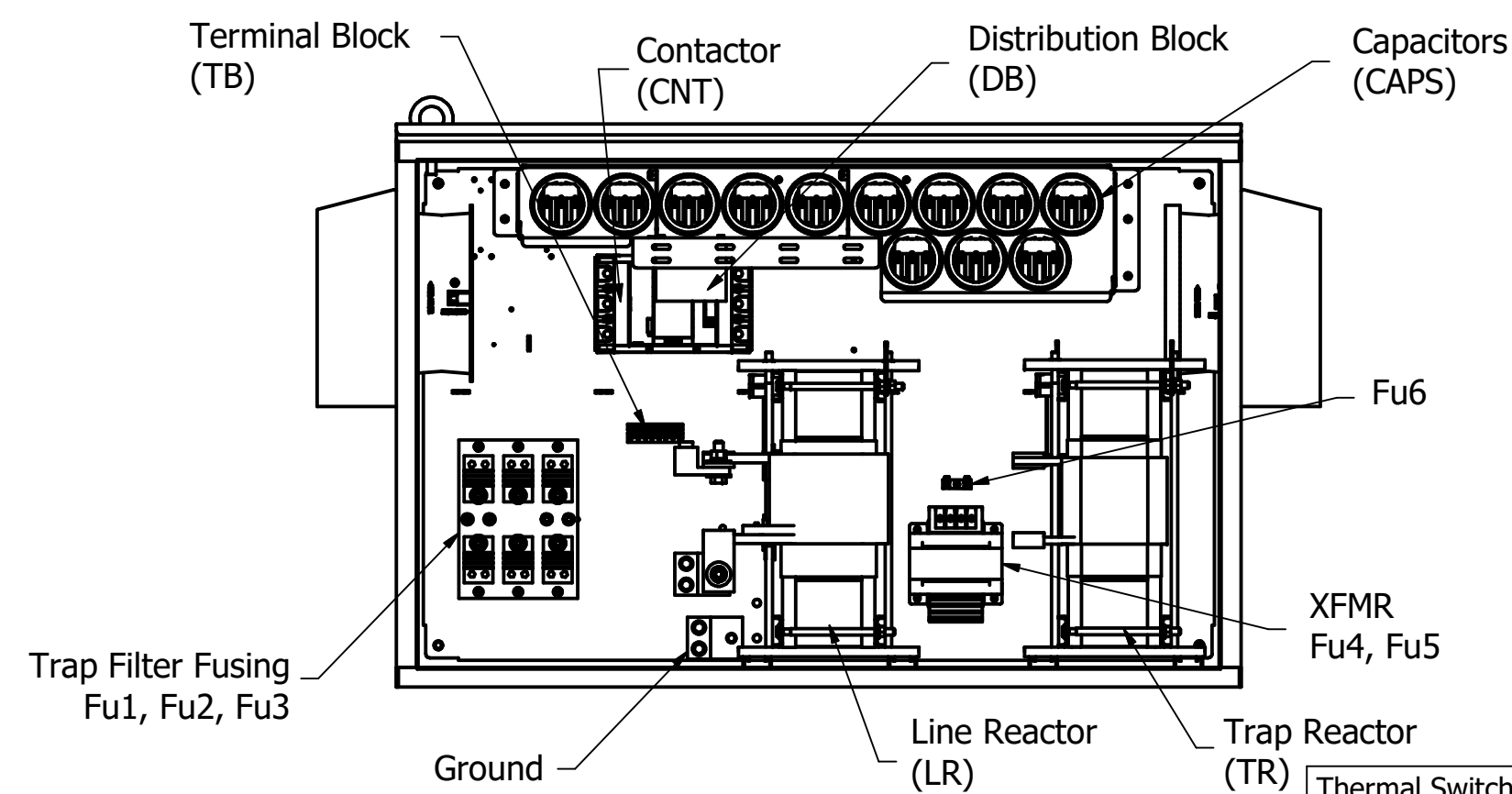
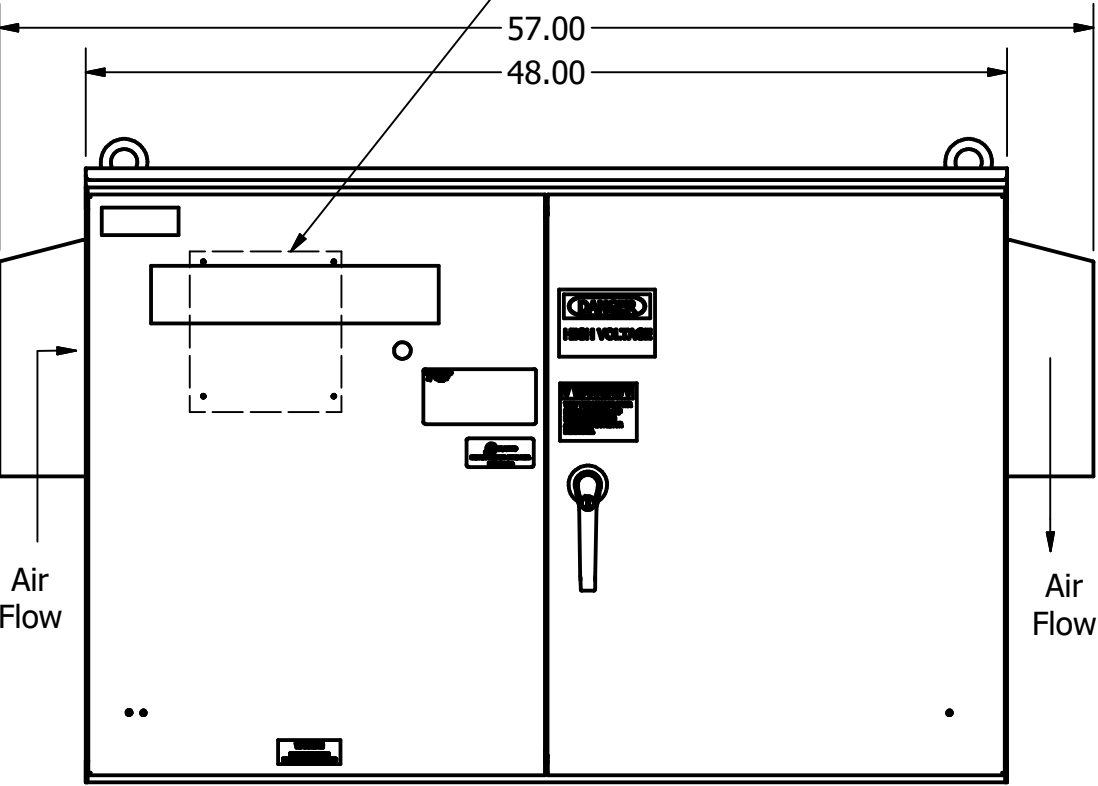
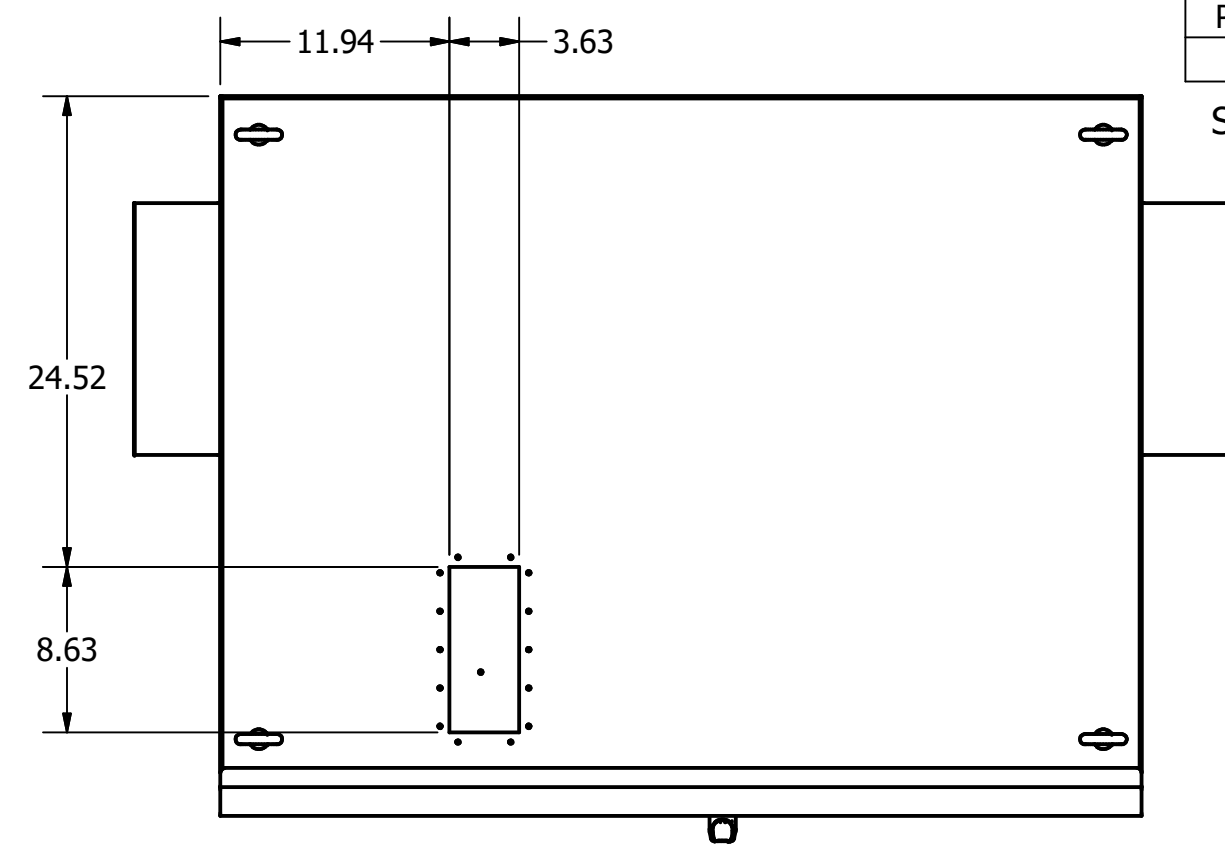
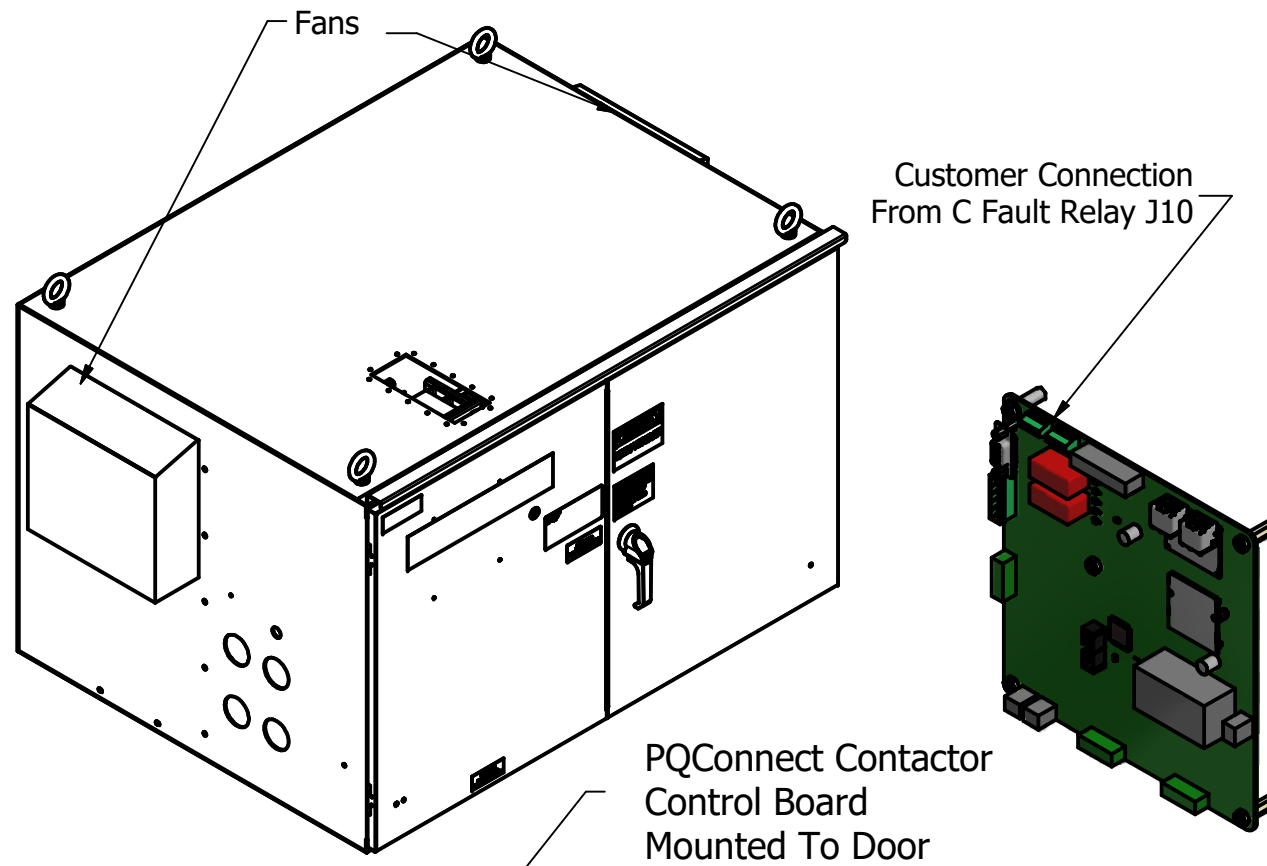

Thermal Switches Installed In Line Reactor And Tuning Reactor Wired To PQconnect For Monitoring

1/4-20 Tapped Holes 6 Places

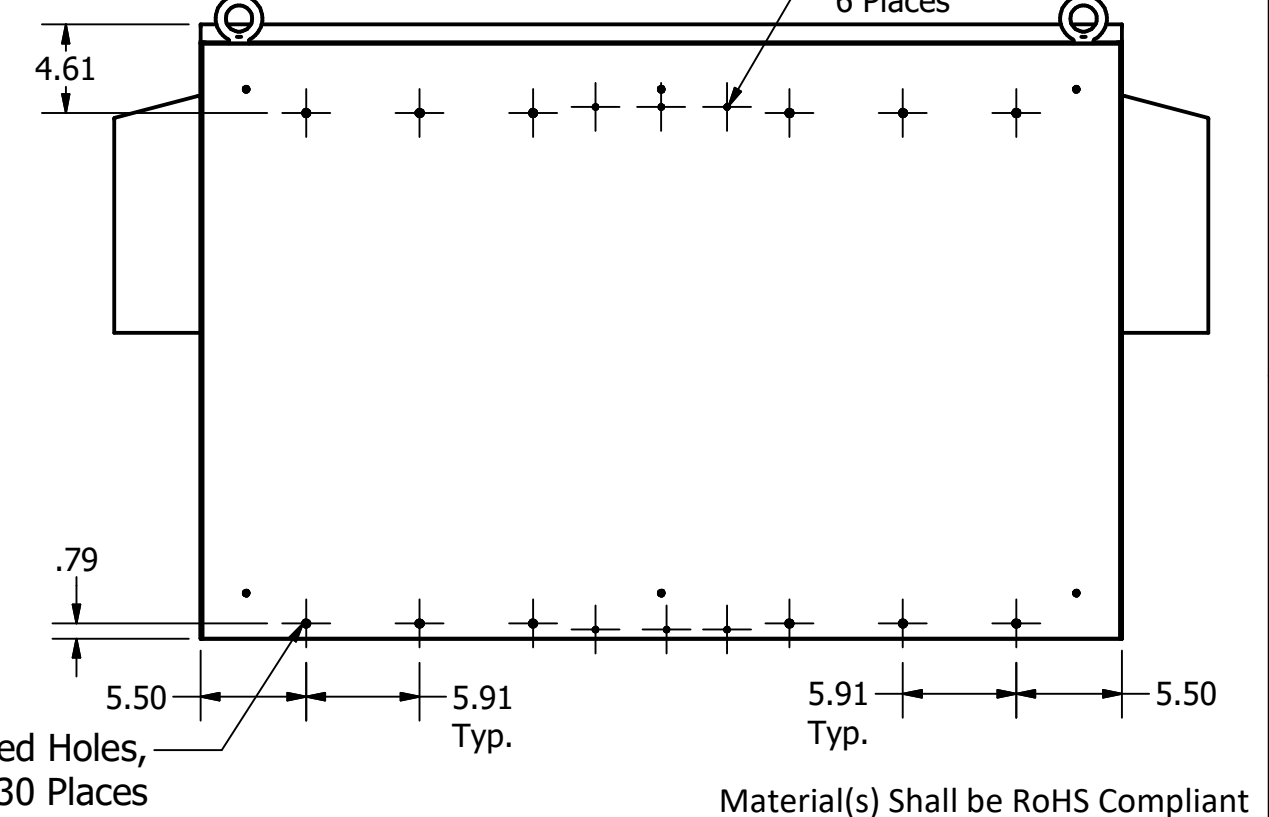
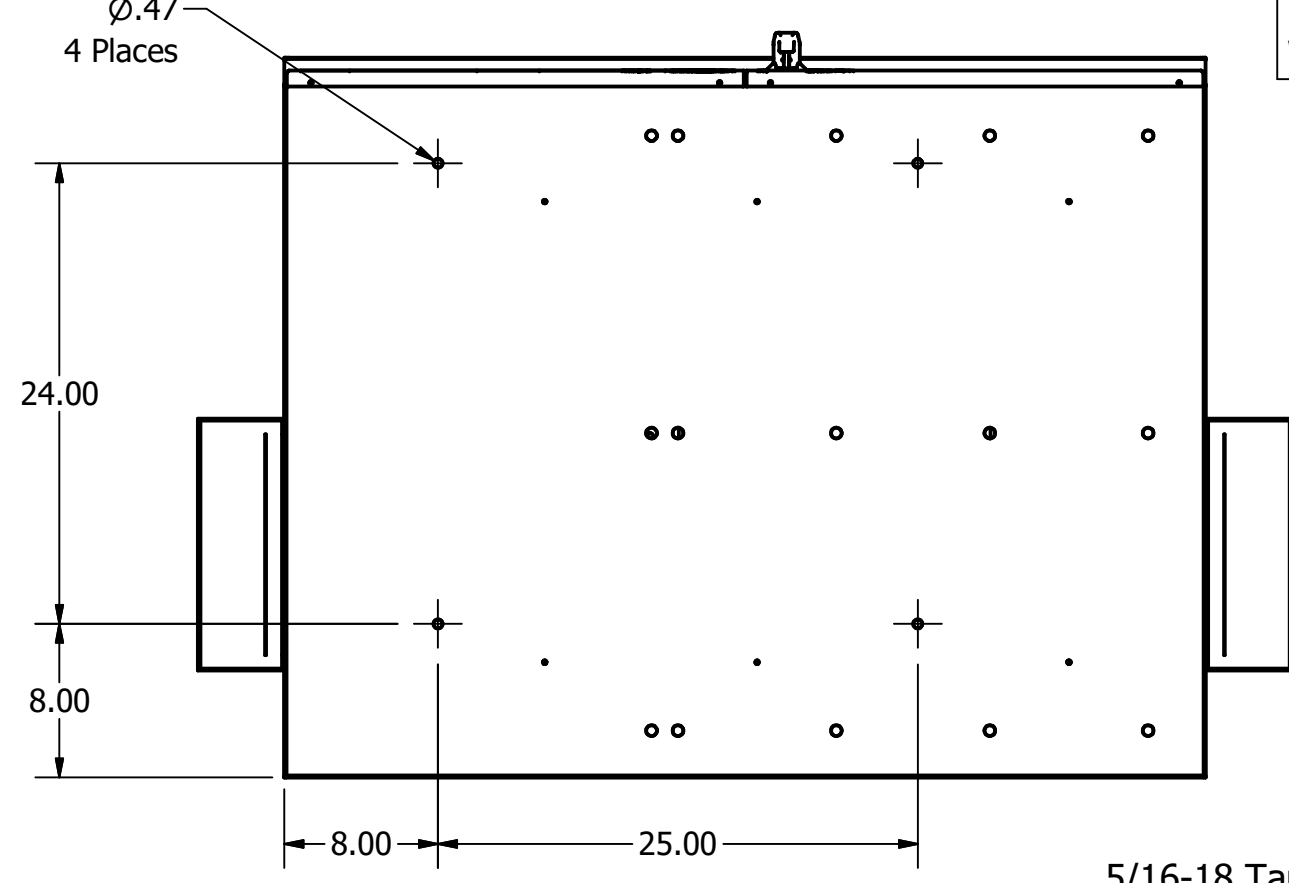
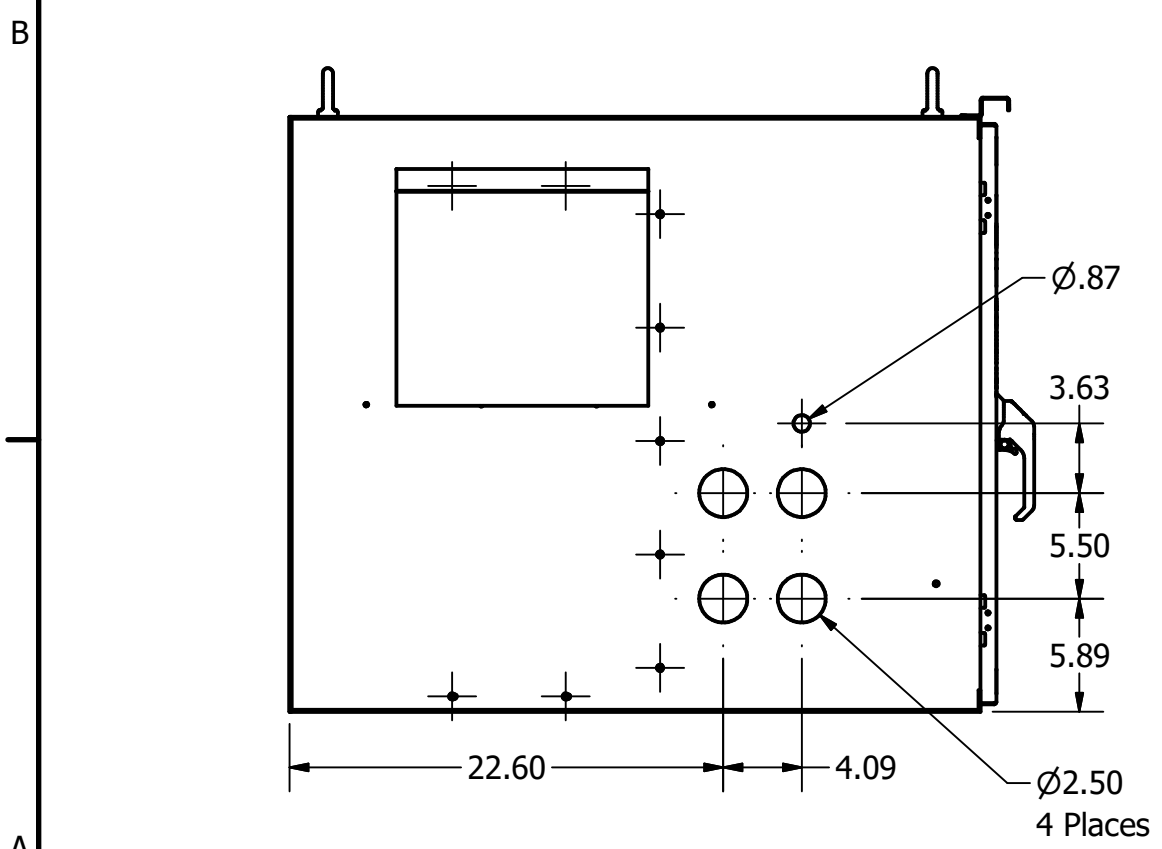

Material(s) Shall be RoHS Compliant

| | | | | | |
|---|----|--------------------------|----------|------------------------------|---|
| <p>THE INFORMATION AND DESIGNS CONTAINED IN THIS DRAWING ARE CONFIDENTIAL AND THE PROPRIETARY PROPERTY OF ALLIED MOTION TECHNOLOGIES INC. AND ITS SUBSIDIARIES. NEITHER THIS DESIGN NOR ANY INFORMATION CONTAINED IN THIS DRAWING MAY BE REPRODUCED OR DISCLOSED TO OTHERS WITHOUT THE EXPRESS WRITTEN CONSENT OF ALLIED MOTION TECHNOLOGIES INC. AND ITS SUBSIDIARIES.</p> | | | | TOLERANCES (EXCEPT AS NOTED) | <p>W132N10611 Grant Drive Germantown, WI 53022 © 2022 TCI, LLC</p> <p>HarmonicGuard Passive, 355kW, 380-415/3/50 Type 3R, JCI, PQconnect, No Front Hoods</p> <p>DRN BY: JRN DATE: 05/06/22 108643-02DG SCALE: 1/10 APRVD: SIZE: C SHT. 1 OF 1</p> |
| | | | | DECIMAL | |
| | | | | .XX ± | |
| | | | | .25.XXX ± | |
| | | | | .10 | |
| | B | 6114 Updated/Added Holes | 01/05/23 | JRN | FRACTIONAL ± 1/32 |
| | A | As Designed | 05/06/22 | JRN | ANGULAR ± 1° |
| | NO | REVISION | DATE | BY | |

4 3 2 1